



# CompAir

by Gardner Denver

## Reliability & efficiency without compromise

Lubricated Rotary Screw Compressors



**L07 - L22**  
**L07RS - L22RS**

Fixed & Regulated Speed

Premium compressor design

# Excellence in every detail

## The L-Series from CompAir

Well known in the industry for quality and reliability, CompAir continuously develops the L-Series to achieve cutting edge performance and efficiency. The L07-L22 range of lubricated screw compressors comprise of fixed speed and regulated speed (RS) models and is available as a complete package including air receiver and refrigerant dryer.

▶ **Pressure range**

7.5 to 13 bar

▶ **Volume flow**

0.41 to 3.65 m<sup>3</sup>/min

▶ **Motor power**

7.5 to 22 kW



**GERMAN**   
**ENGINEERING**  
& **DESIGN**

## Engineering excellence

Compressors are more than just a financial investment, they are a key component in ensuring that manufacturers, processors and operators receive consistent, high quality low cost air.

The screw compression element is the heart of the compressor and therefore CompAir keeps the design and manufacture in-house, using the latest CNC rotor grinding machinery, coupled with online laser technology.

The resulting reliability and performance ensure that operating costs will remain low throughout the compressor's life.

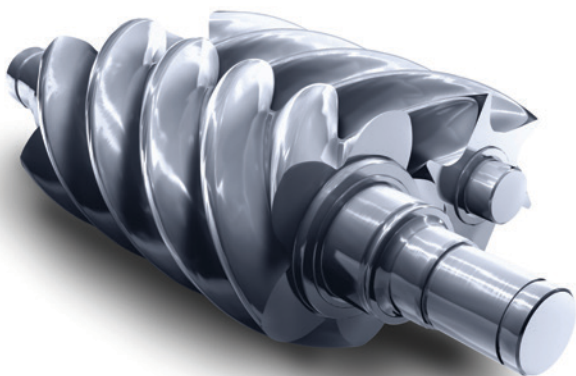

“

CompAir lubricated rotary screw compressors incorporate the very latest technological advances and guarantee a continuous supply of high quality compressed air.

”

## A design concept based on reliability and flexibility

### Fully integrated airend

The advanced design of the high efficiency airend allows operation at low rotational speeds, and consequently lowers the energy costs. The innovative integrated design, including oil separation, oil filter and thermostatic bypass valve, reduces the number of external hoses and components offering excellent reliability.

### Combined air/oil cooler

Equipped with a bypass for rapid warm-up and control of the oil temperature, reducing wear, eliminating condensate in the compressor system and providing low air discharge temperature.

### High efficiency electric motor

The compressors are equipped with an energy saving IE3 electric motor with reduced CO<sub>2</sub> emissions.

### Automatic belt tensioning system

The maintenance-free system provides automatic and accurate belt tension and extends the belt life.

### Factory-filled lubricant

Reduces service costs by extending the oil change period to up to 4,000 hours.

### Low noise levels

Allows the compressor to be placed at the point of use.

### Up to 45°C ambient temperature

Reliable operation, even in challenging environments.

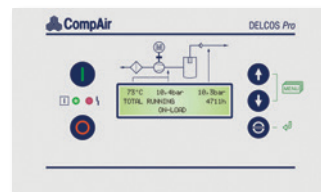

## Delcos Pro compressor controller

The control system ensures reliable operation and protects the investment by continuously monitoring operational parameters. The Delcos Pro also has the capability to have programmable inputs and outputs, control additional equipment as well as providing the following features in clear readable text:

- Discharge/line pressure display
- Air/oil temperature display
- Total hours run and under load
- Service due indicator
- Enhanced fault log monitor
- Real time clock
- Timer controlled stop/start
- Remote start/stop
- Auto restart after power failure
- Second pressure setting
- Status indication
- RS485 - Modbus RTU

### Ergonomic controller positioning

Controller can be positioned on top or front of the compressor.



## Regulated Speed Compressors

### The perfect response to individual air demand

Regulated speed compressors from CompAir can efficiently and reliably handle the varying air demand found in most plant air systems.

The annual cost of ownership can be significantly reduced using regulated speed technology.

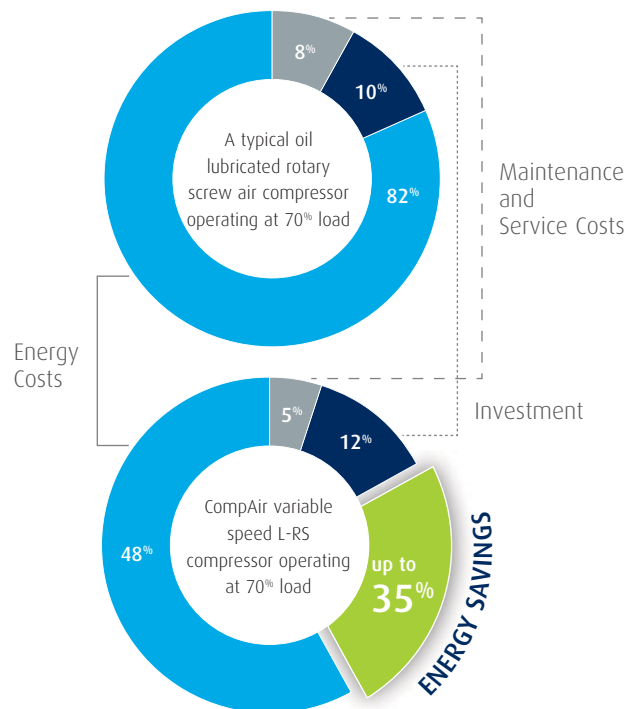

### Tried and tested inverter concept

- Integrated in the electric cabinet
- Protected from dust by replaceable inlet filters
- Maximum reliability from optimised cooling system
- Ensures high availability and long-life

### CompAir RS features are your benefits

The L-RS Series products are designed to obtain the greatest efficiency across the entire operating range.

- ▶ **Wide regulation range**  
No cycles means substantial energy savings
- ▶ **Perfect motor - drive - airend design**  
High efficiency across broad flow range

# AirPlus

## The complete packaged solution

CompAir offers complete Airstations from 7 to 22 kW including compressor, refrigerant dryer and air receiver.



### Easy to install, easy to use

All components are perfectly matched and ready for "Plug and Play".

### High quality air receiver

Built to the highest standards and are inspection-free for up to five years.

### Minimum Footprint

By mounting the components on the receiver, the required floor space is reduced by 55%.

## Integrated heat recovery

From 15 kW, the compressors are available with highly efficient heat recovery systems, which can be factory fitted or are available as retrofit kits comprising all the necessary pipe-work and fittings.



Scan QR code to watch heat recovery video and access energy savings calculation tool.

## Compressed air purification

A modern production system and process demands increasing levels of air quality. A CompAir compressed air system utilising the latest technology provides an energy efficient solution at lowest life cycle costs.

### Water Cyclone Separator X Series

Designed for efficient removal of bulk liquid contamination from compressed air.



### Compressed Air Filter CF Series

Efficient design for water, dust and particle removal.

### Condensate Drain Bekomat System

To drain compressed air condensate without loss of compressed air.

### Compressed Air Refrigerant Dryer

CompAir offer a full range of energy efficient and environmentally friendly stand alone refrigerant dryers.



### Heatless Desiccant Dryers

Series A\_XS and A\_TX.

### Heat Regenerative Desiccant Dryers

Series A\_TV and A\_RS.

### Nitrogen Generator

Designed to achieve maximum efficiency and gas quality.



### SmartAir Master Multi Compressor Controllers

Sequencers for up to 12 units.



# Protect your investment



## Assure warranty – to ensure your peace of mind!

The CompAir Assure Warranty and Service programmes will assure you up to 44,000 hours/6 years <sup>1)</sup>. It is one of the most generous warranties available in the industry affording you total piece of mind.

### Your benefits:

- The Assure warranty is totally free to the compressor owner <sup>2)</sup>
- The CompAir authorised service provider will deliver a guaranteed quality of service
- An Assure service agreement underpinning the warranty will enable accurate maintenance budgeting and cost of ownership
- The use of genuine CompAir parts and lubricants will maximise compressor life and efficiency

<sup>1)</sup> whichever is the soonest

<sup>2)</sup> subject to Terms & Conditions



## Advanced design - Easy servicing

The design of these packages ensures the service points are readily accessible.

With all service components conveniently grouped behind a lift-off canopy section, downtime and service costs are kept to a minimum.

Furthermore all component parts are designed for a long service life. The generously sized suction filters, oil filters and final separators ensure long service life and excellent compressed air quality.

### First-class accessibility

- Panels and covers are easily removable with quick-release catches.

### Easy service items

- Spin on/off separator cartridge providing residual oil carryover of less than 3 mg/m<sup>3</sup>
- Quick oil change via external drain
- Easy access suction filter element

## CompAir genuine spare parts

### Enjoy complete peace of mind.

Genuine CompAir parts and lubricants ensure that compressed air plant reliability and efficiency is maintained at the highest standards. CompAir spare parts and lubricants are distinguished by:

- Long service life, even under harshest conditions
- Minimum losses contribute to energy savings
- High reliability improves plant up-time
- Products manufactured with the strictest Quality Assurance Systems

# CompAir L-Series - Technical Data

## L07 - L22 Fixed Speed



Compressor Model	Nominal Pressure [bar g]	Drive Motor [kW]	FAD <sup>1)</sup> [m <sup>3</sup> /min]	Noise Level <sup>2)</sup> [dB(A)]	Weight [kg]	Dimensions L x W x H [mm]
L07	7.5	7.5	1.30	70	205	667 x 630 x 1050
	10		1.06			
	13		0.85			
L11	7.5	11	1.82	70	219	667 x 630 x 1050
	10		1.61			
	13		1.32			
L15	7.5	15	2.70	70	335	787 x 698 x 1202
	10		2.26			
	13		1.80			
L18	7.5	18.5	3.25	71	361	787 x 698 x 1202
	10		2.74			
	13		2.34			
L22	7.5	22	3.65	71	367	787 x 698 x 1202
	10		3.21			
	13		2.61			

## L07RS - L22RS Regulated Speed

Compressor Model	Nominal Pressure [bar g]	Drive Motor [kW]	FAD <sup>1)</sup> [m <sup>3</sup> /min]		Noise Level at 70% load <sup>2)</sup> [dB(A)]	Weight [kg]	Dimensions L x W x H [mm]
			min.	max.			
L07RS	7.5	7.5	0.48	1.26	63	222	667 x 630 x 1050
	10		0.44	1.01			
	13		0.41	0.83			
L11RS	7.5	11	0.63	1.81	64	231	667 x 630 x 1050
	10		0.64	1.56			
	13		0.57	1.26			
L15RS	7.5	15	0.92	2.60	67	365	787 x 698 x 1202
	10		0.86	2.18			
	13		0.83	1.67			
L18RS	7.5	18.5	1.33	3.05	68	381	787 x 698 x 1202
	10		1.28	2.62			
	13		1.22	2.20			
L22RS	7.5	22	1.04	3.54	69	386	787 x 698 x 1202
	10		0.93	3.15			
	13		0.90	2.66			

## L07 - L22 / L07RS - L22RS Airstation

Compressor Model	Nominal Pressure [bar g]	Refrigeration Dryer <sup>3)</sup> [type]	Air Receiver [Volume]	Air Outlet	Weight [kg]	Dimensions L x W x H [mm]
L07 / L07RS	7.5	F12HS-BO	270 litres	RP ¾"	336 / 353	1541 x 695 x 1577
	10					
L11 / L11RS	7.5	F18HS-BO	270 litres	RP ¾"	350 / 362	1541 x 695 x 1577
	10					
L15 / L15RS	7.5	F30HS-BO	500 litres	RP 1"	545 / 575	1883 x 815 x 1825
	10					
L18 / L18RS	7.5	F39HS-BO	500 litres	RP 1"	617 / 637	1883 x 815 x 1825
	10					
L22 / L22RS	7.5	F39HS-BO	500 litres	RP 1"	622 / 641	1883 x 815 x 1825
	10					

<sup>1)</sup> Data measured and stated in accordance with ISO 1217 Ed. 4, Annex C & Annex E and the following conditions:  
Air Intake Pressure 1 bar a, Air Intake Temperature 20° C, Humidity 0 % (dry)

<sup>2)</sup> Measured in free field conditions in accordance with ISO 2151 and ISO 9614-2, tolerance ± 3 dB(A).

<sup>3)</sup> The refrigerant dryer requires a separate electric supply. Data refer to DIN ISO 7183, 8573-1:2001 (class 4, pressure dew point 3° C). For further specifications please refer to refrigerant dryer documentation.

# Global experience – truly local service

With over 200 years of engineering excellence, the CompAir brand offers an extensive range of highly reliable, energy efficient compressors and accessories to suit all applications.

An extensive network of dedicated CompAir sales companies and distributors across all continents provide global expertise with a truly local service, ensuring our advanced technology is backed up with the right support.

As part of the worldwide Gardner Denver operation, CompAir has consistently been at the forefront of compressed air systems development, culminating in some of the most energy efficient and low environmental impact compressors on the market today, helping customers achieve or surpass their sustainability targets.



## CompAir compressed air product range

### Advanced Compressor Technology Lubricated

- Rotary Screw
  - > Fixed and Regulated Speed
- Piston
- Portable

### Oil-Free

- Water Injected Screw
  - > Fixed and Regulated Speed
- Two Stage Screw
  - > Fixed and Regulated Speed
- Piston
- High Speed Centrifugal - Quantima®
- Rotary Scroll

### Complete Air Treatment Range

- Filter
- Refrigerant and Desiccant Dryer
- Condensate Management
- Heat of Compression Dryer
- Nitrogen Generator

### Modern Control Systems

- CompAir DELCOS Controllers
- SmartAir Master Sequencer
- iConn - Smart Flow Management

CompAir policy is one of continuous improvement and we therefore reserve the right to alter specifications and prices without prior notice. All products are sold subject to the Company's conditions of sale.

### Value Added Services

- Professional Air Audit
- Performance Reporting
- Leak Detection

### Leading Customer Support

- Custom Engineered Solutions
- Local Service Centres
- Genuine CompAir Parts and Lubricants

[www.compair.com](http://www.compair.com) [sales@compair.com](mailto:sales@compair.com)